

1. Locate position of FALSE Jamb for Panel arrangement and direction of slide from possibilities (Fig. 1).

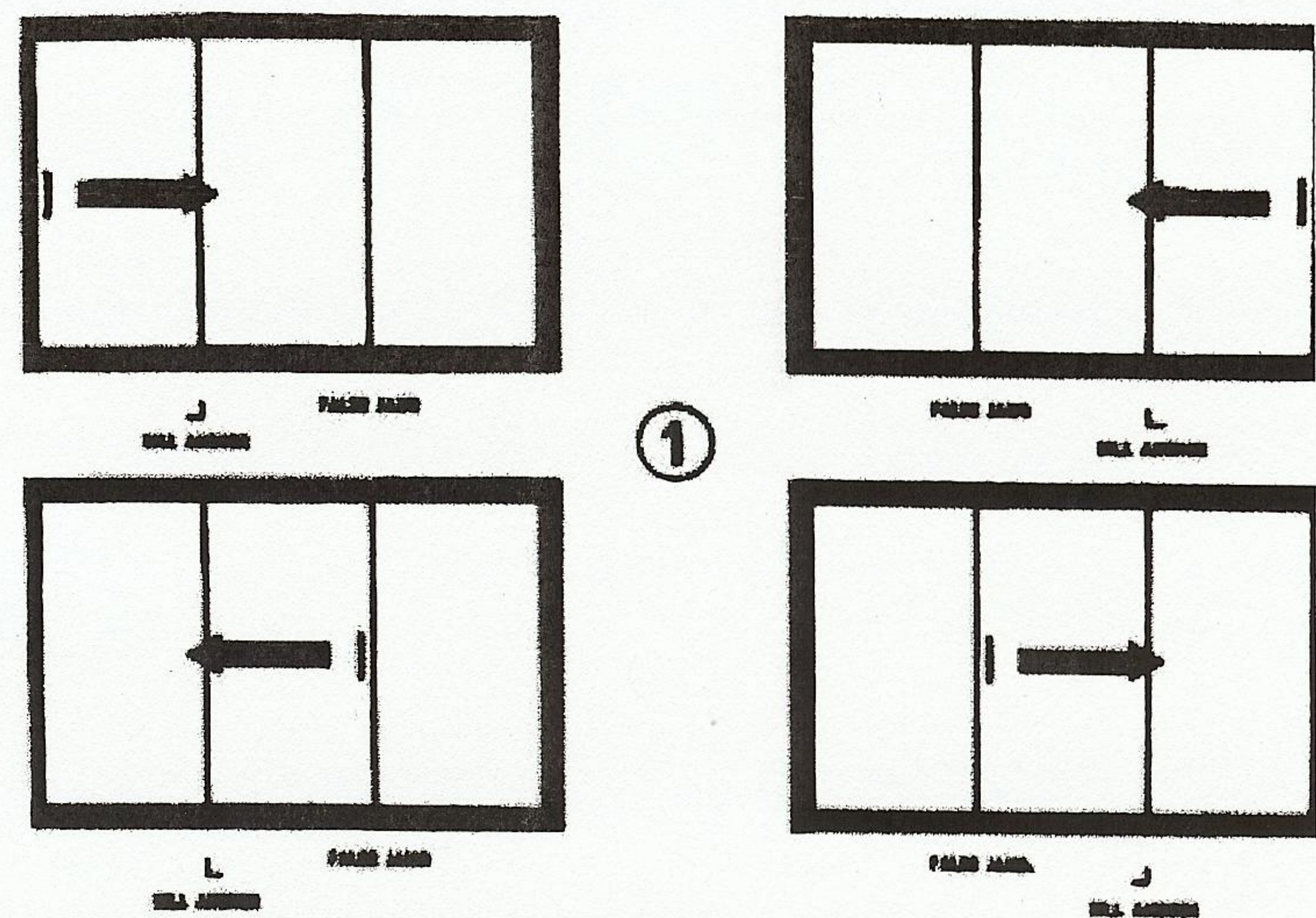

2. To install FIXED PANEL that occurs between the frame jamb and the false jamb, insert panel up into the middle channel of the frame at the head and lower into the THRESHOLD RECESS. Slide panel as far as possible into the frame jamb pocket (Fig. 3).





3. Install anchors into HEAD and SILL ends of false jamb as shown with #8 x 1/2" truss head self-tapping screws (Fig. 3).

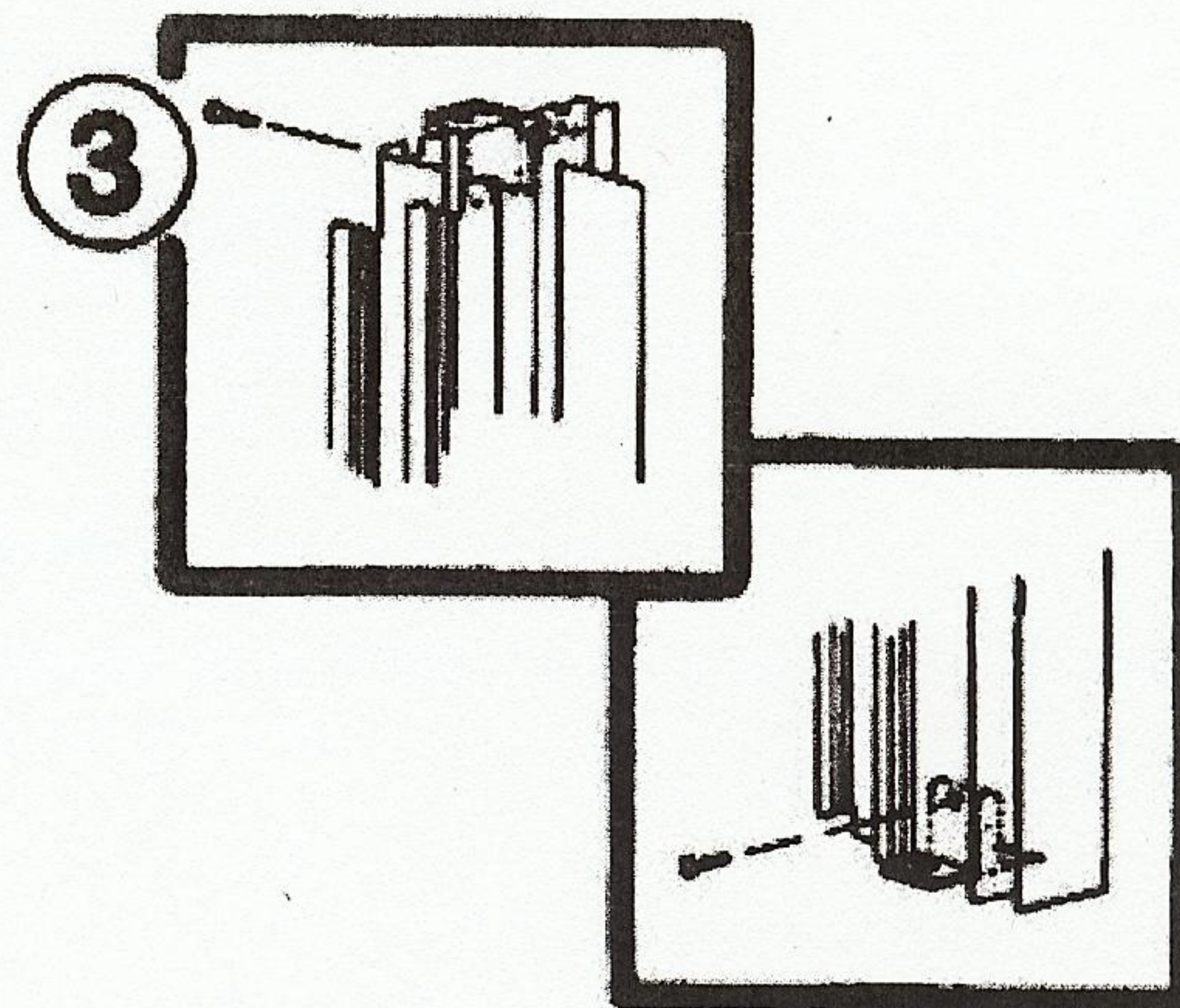

4. Install false jamb against fixed panel installed in step 2. BE SURE fixed panel is pocketed fully into false jamb (Fig. 4).

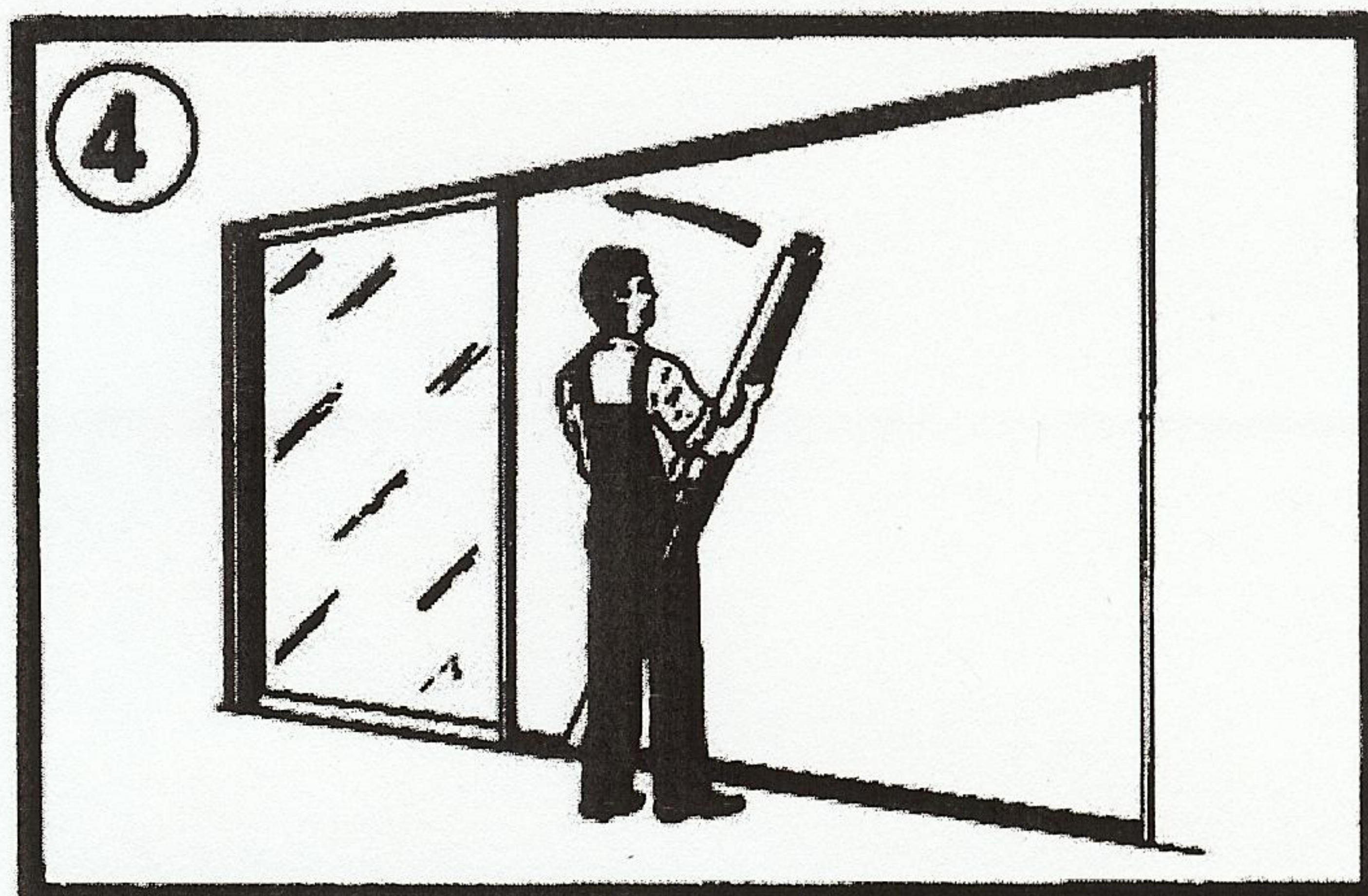

5. SECURE false jamb head and sill anchors to frame with #8 x 1/2" truss head self-tapping screws (Fig. 5).

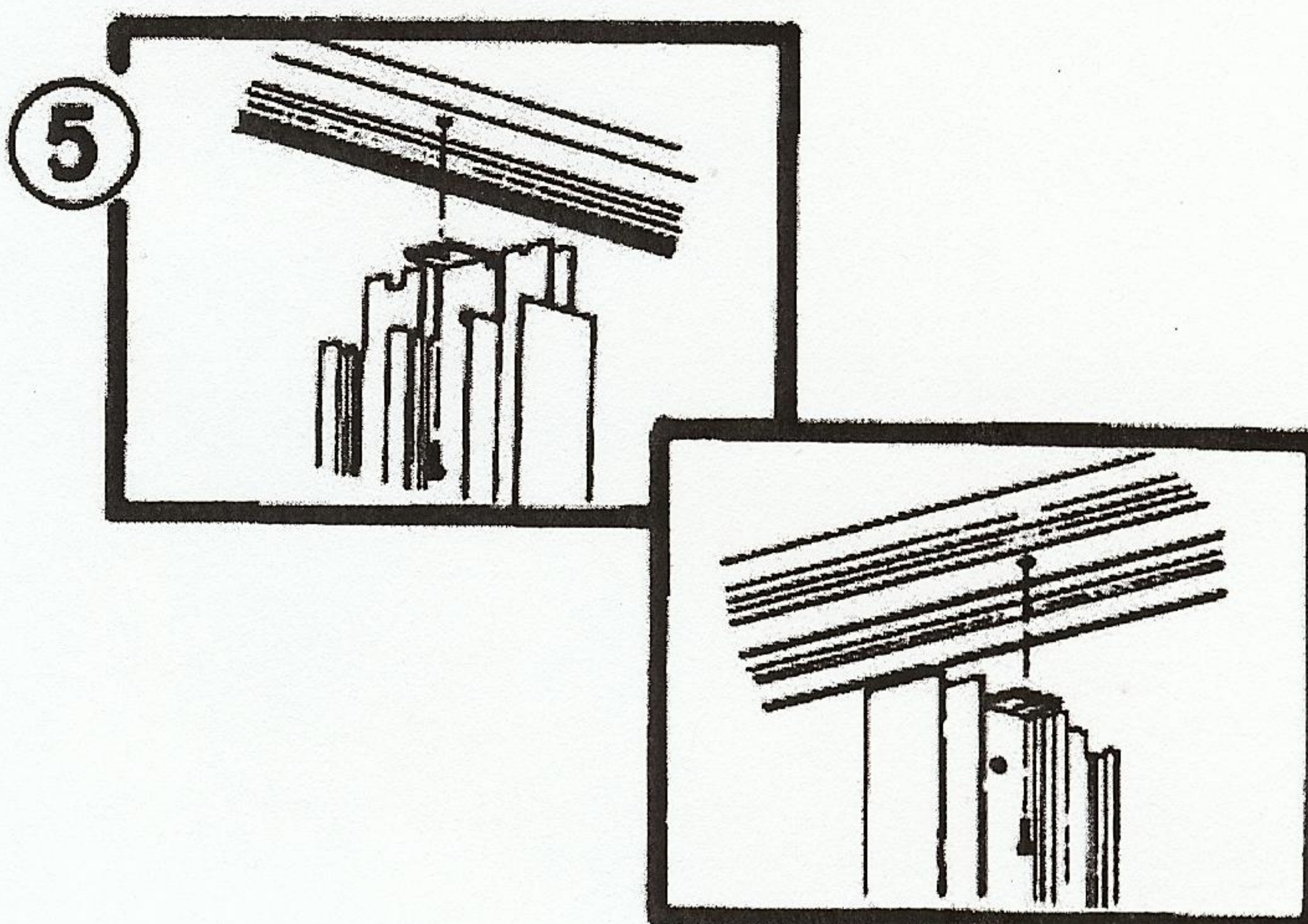



6. SECURE fixed panel sill anchor to vertical stile of second fixed panel with #8 x 1/2" truss head self-tapping screws. Be sure ANCHOR is secured to the stile that will occur between the frame jamb and false jamb (Fig. 6).

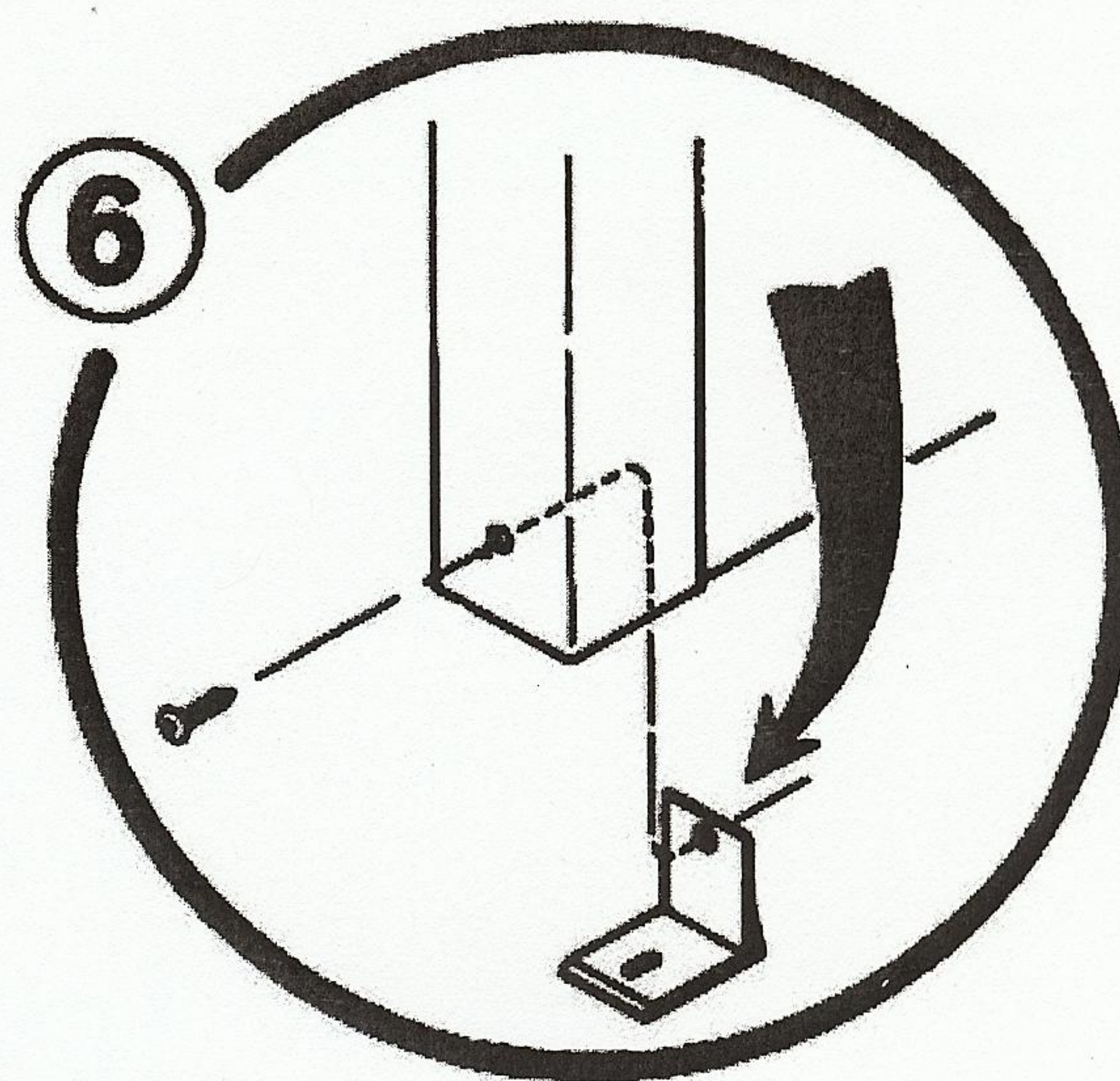

7. Insert SECOND FIXED PANEL up into the middle channel of the frame at the head and lower into the THRESHOLD RECESS. Slide panel as far as possible into the jamb pocket (Fig. 7).





8. SECURE head anchor to head and secure sill anchor to threshold with #8 1/2" truss head self-tapping screws (Fig. 8).



9. INSERT OPERATING PANEL into head and lower onto the threshold track. MAKE SURE vinyl sweeps are clear of track (Fig. 9).





10. ADJUST ALIGNMENT of sliding panel by using adjustment screws in rollers at bottom (both sides) for correct alignment of operating panel with frame (Fig 10).

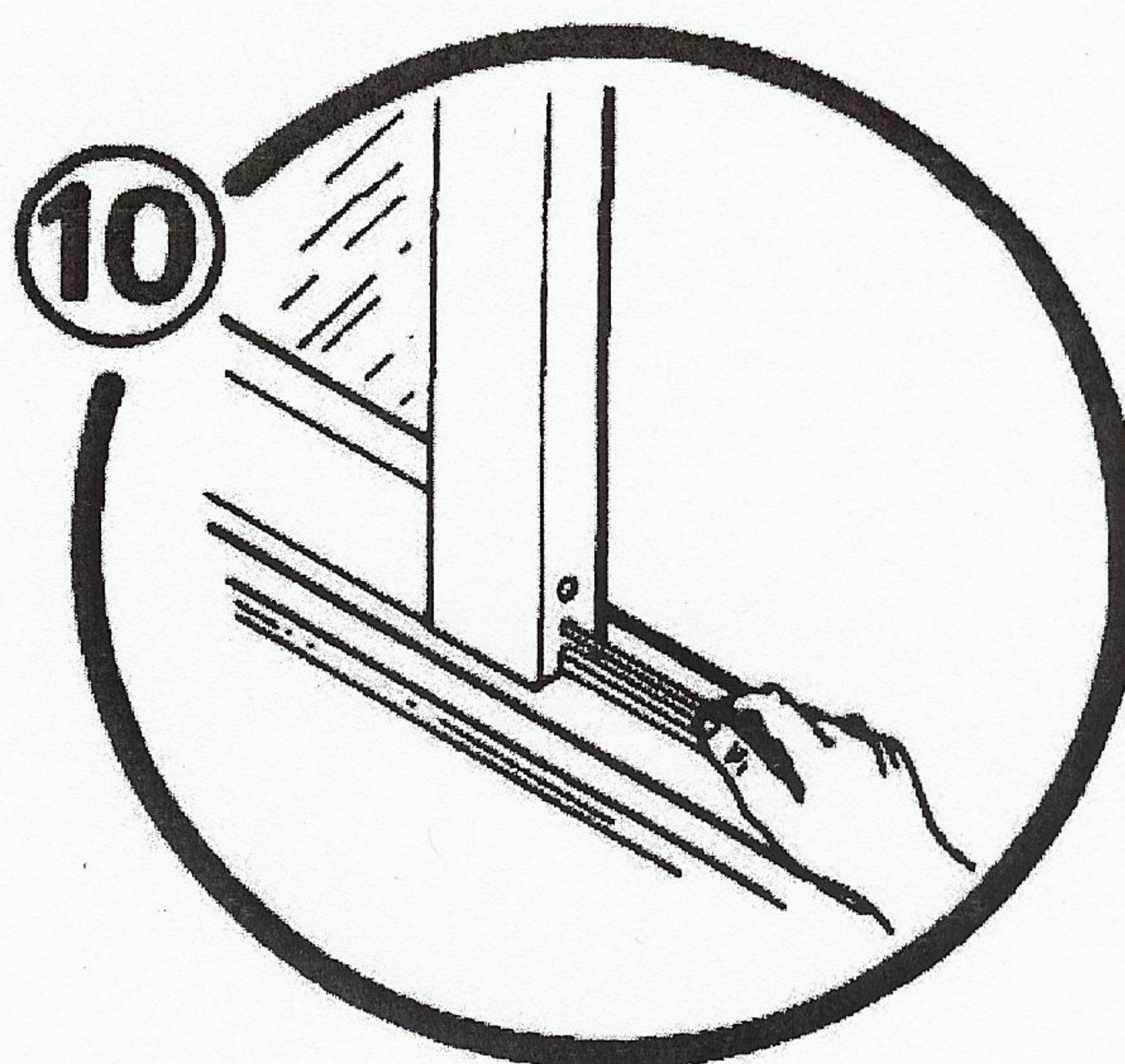

11. Install rubber bumpers into lock stile (Fig. 11).

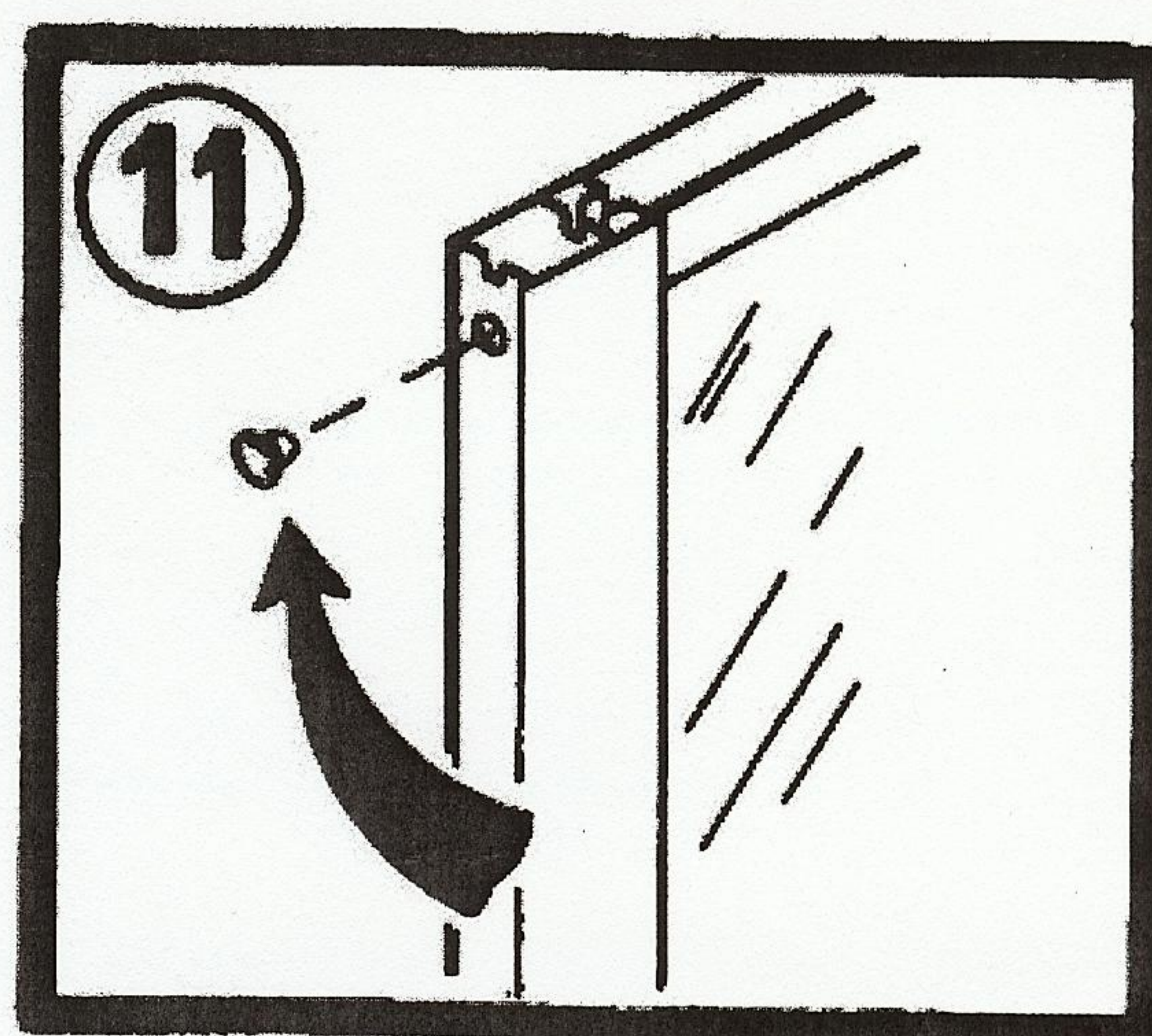



12. Install handle set as shown (Fig. 12).

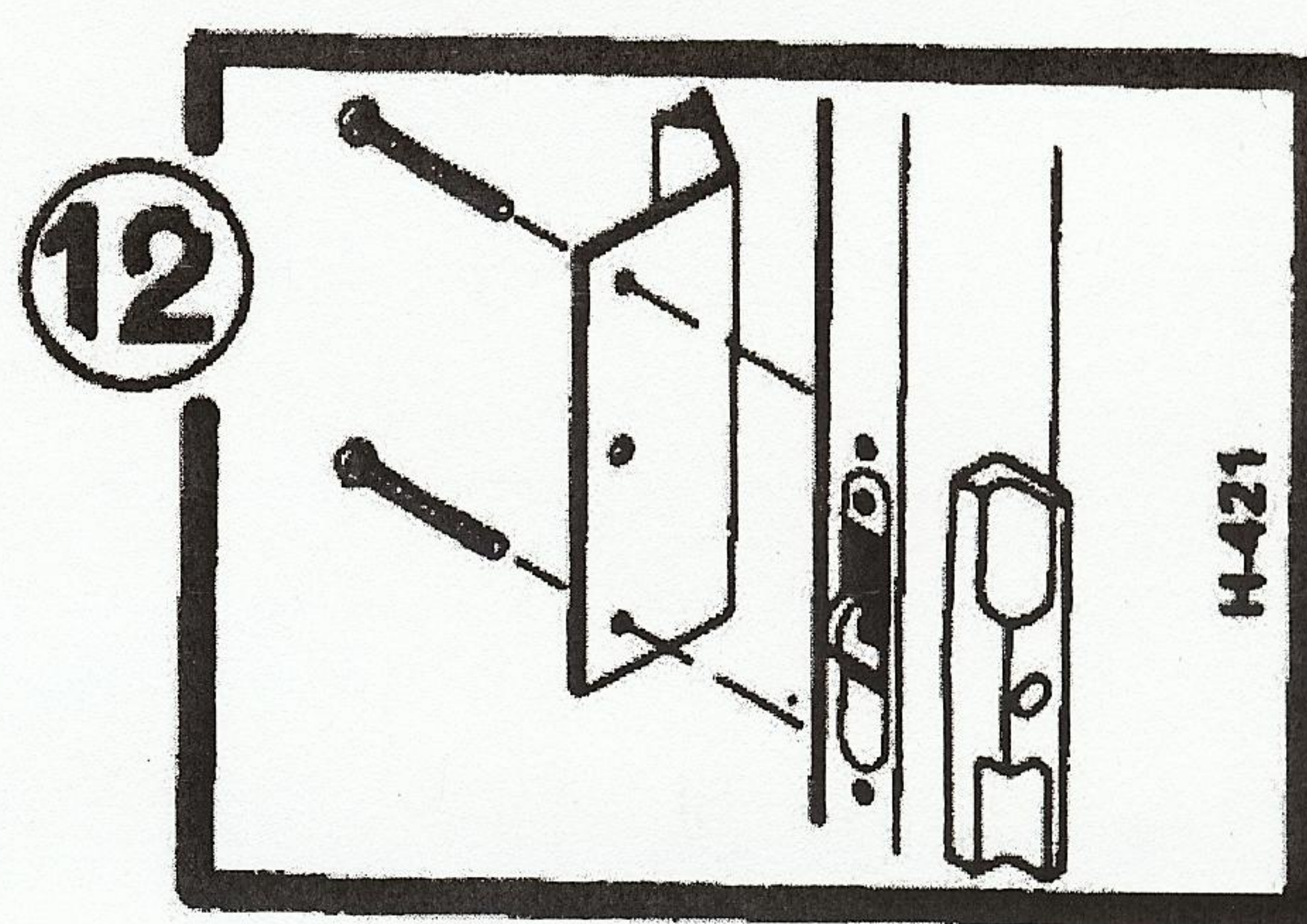

13. ADJUST LOCK THROW so lock engages frame properly (Fig. 13).

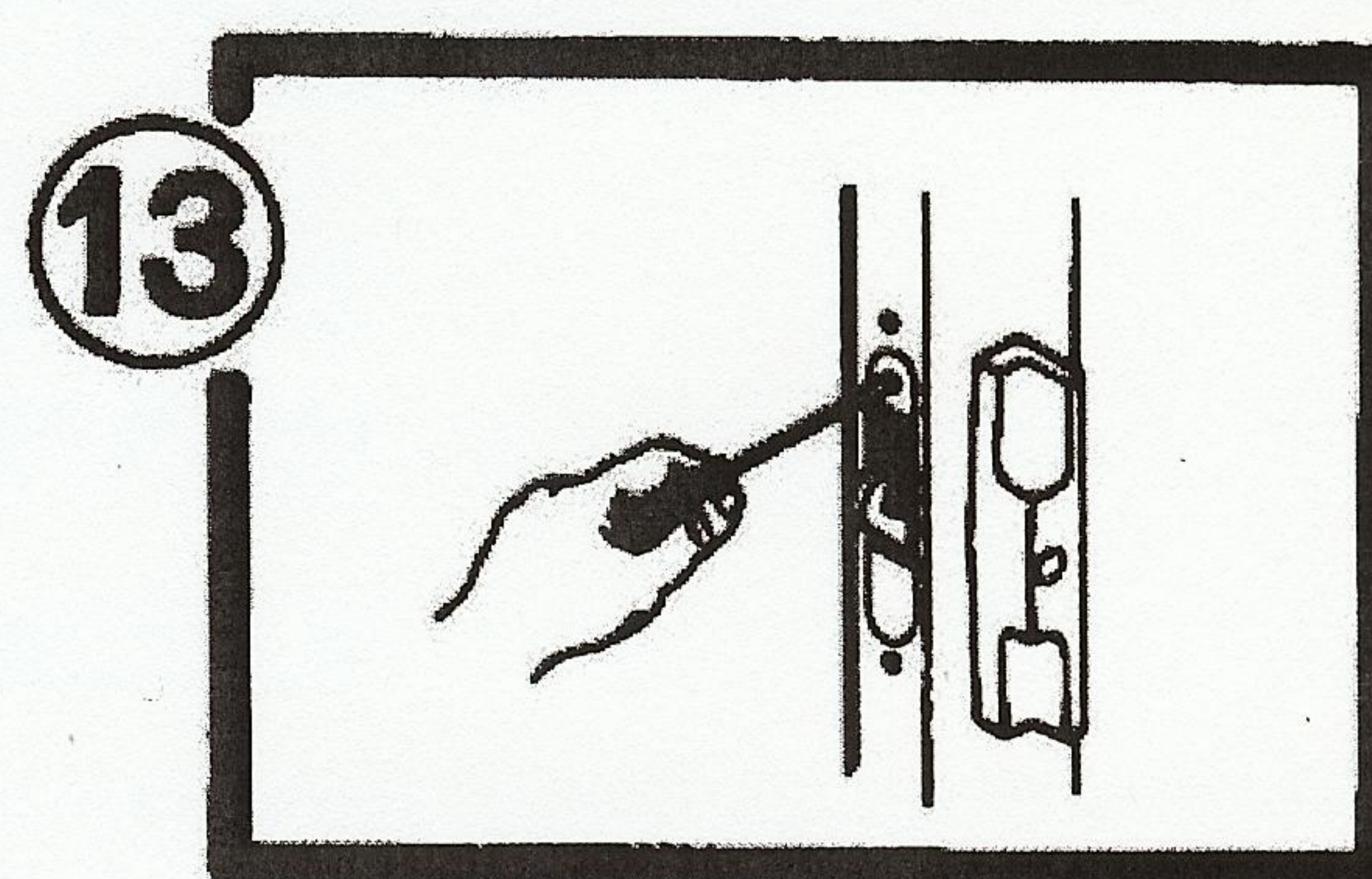



14. INSTALL cover plate(s) in false jamb where lock slot (s) occurs (Fig. 14).

